

ATLAS
EQUIPMENT CO.

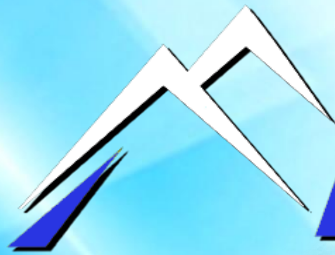

IRON *M T N*
PUMPS

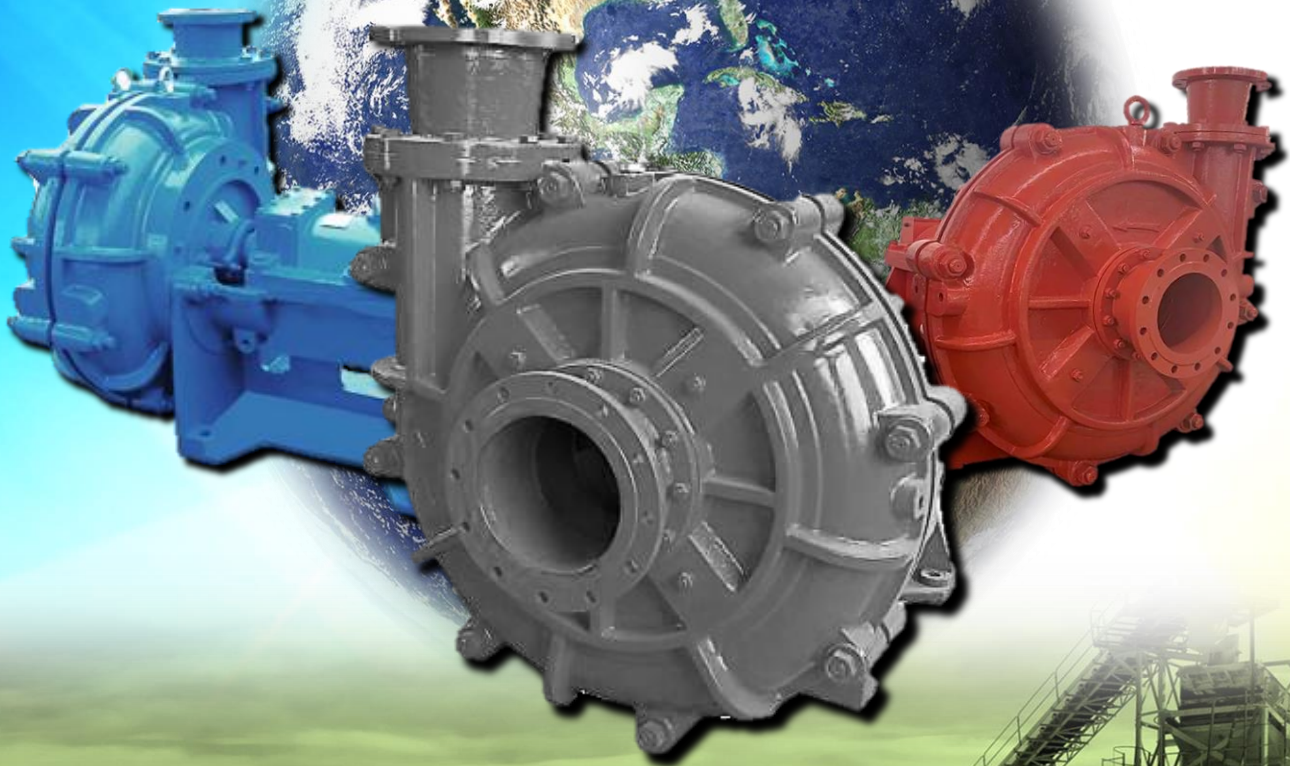

SEVERE-Duty Slurry Pumps

IronMTN® SEVERE-Duty Pump Design

SPOOLS:

- Compatible with ANSI or DIN flanges
- Drilled Pipe Flanges not required for easier PM

IMPELLER:

- Larger Diameter for higher head at lower speed
- Twist-design vanes for improved efficiency

VOLUTE, IMPELLER, &

WEAR PLATES:

Available with hard alloy materials to maximize wear & corrosion resistance

OUTER CASING:

- Designed with tangential discharge & horizontal inlet.
- Discharge flange rotatable in 45 deg. Increments.
- Constructed of DCI or steel based on working pressure required

EXTERNAL IMPELLER ADJUSTMENT:

OE performance maintained by jack-screw adjustment w/o need for disassembly

RUGGED SHAFT:

Shaft made of heat-treated alloy steel, designed for continuous service under the most extreme conditions (min. shaft deflection)

HD BEARING FRAME:

Strong 2-Piece Design, using horizontal split for easy disassembly; large oil sump std.

STUFFING BOX:

- 3 Box Configurations Available: packed box, expeller & mech. seal;
- Hardened sleeve is standard

IMPELLER RELEASE:

Removal of collar releases pressure bet. Impeller & sleeve which allows for much easier impeller removal

IRONCLAD

IRONMTN® PUMPS : DESIGNED FOR SEVERE DUTY PUMPING:

- Capacities up to 9000GPM (2000 m3/hr)
- Heads to 350 feet (100m and 950 BHP)
- Temperatures up to 240F (165C)

SPL SERIES



SPH SERIES



PART	SP MATERIALS OF CONSTRUCTION		
Outer Casings	Cast Iron	Ductile Iron	Cast Steel
Impeller	28% CR Iron	36% CR Allow for Corrosive Applications	15/3 Alloy
Volute Liner			
Wear Plates			
Stuffing Box	Cast Iron	28% CR Iron	35% CR Alloy
Expeller			
Sleeve	420 Stainless Steel at 55 Rc		
Shaft	Carbon Steel		
Bearing Housing	Cast Iron		
Spool Pieces	Cast Iron	Ductile Iron	Cast Steel
Seal Rings	Elastomer		

SEVERE-Duty Slurry Pumps

HYDRAULIC COVERAGE – 60 Hz

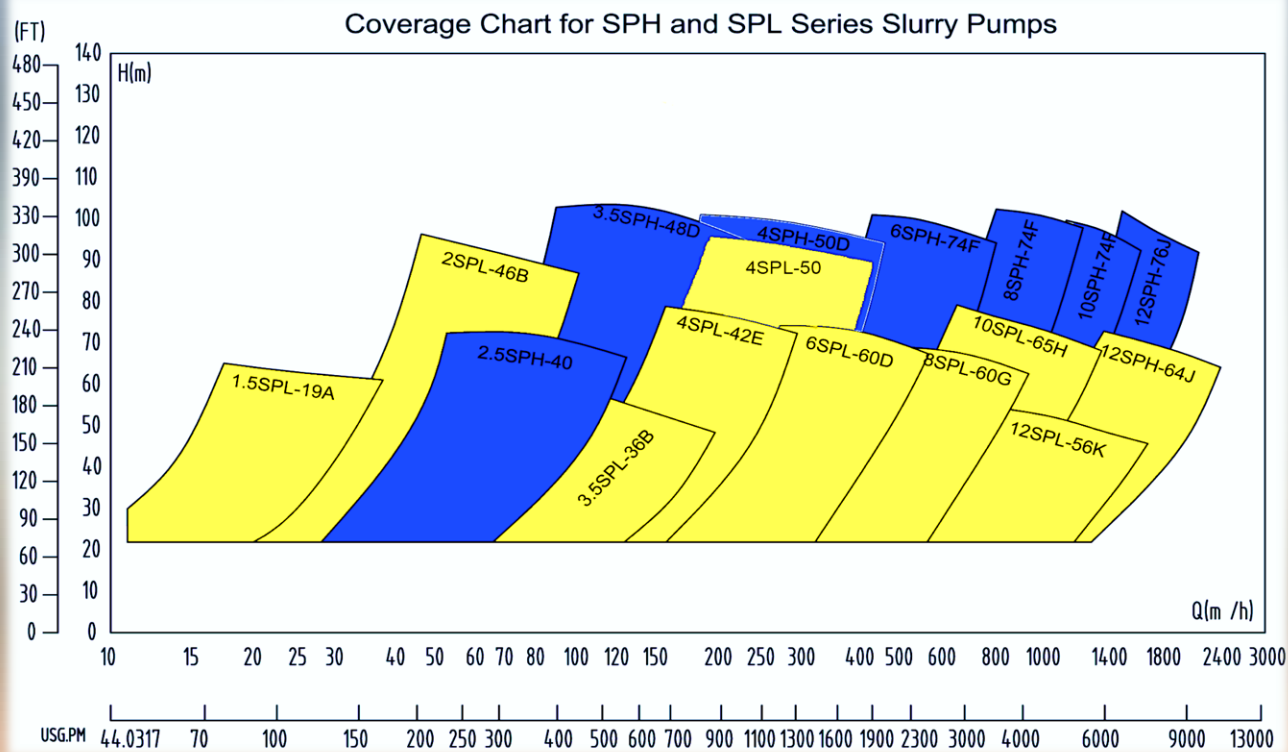

IRON MOUNTAIN PUMPS SPH & SPL Pump Curves

Parts you need...

...without the wait

SEVERE-Duty Slurry Pumps

BARE PUMP – Dimensional Drawing

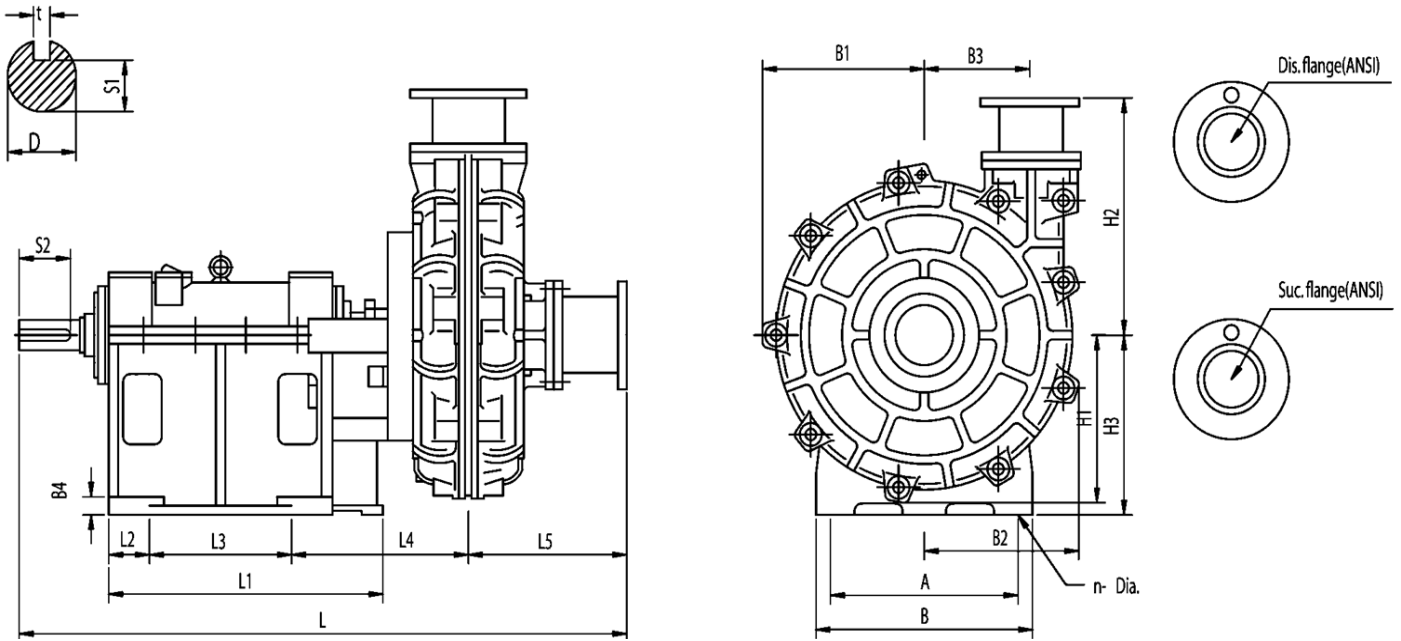

Notes:

1. Do not use for construction unless certified.
2. Rotation is CW when viewed from shaft end.
3. Do not Scale. Additional dimensions will be furnished on request.
4. All dimensions are in inches and millimeters.
5. Suction and Discharge pipes must be independently supported.

Model	A	B	B1	B2	B3	B4	H1	H2	H3	L	L1	L2	L3	L4	L5	No. / Dia	S1	S2	D	T	Suct	Disc
1.5SPL-19A (in)	15.75	17.72	6.49	6.87	4.40	0.78	6.49	10.24	6.69	23.46	12.32	1.65	8.19	5.87	3.90	4-0.55	0.83	1.97	0.98	0.31	2	1.5
1.5SPL-19A(mm)	400.05	450.09	164.85	174.50	111.76	19.81	164.85	260.10	169.93	595.88	312.93	41.91	208.03	149.10	99.06	4-14	21.08	50.04	24.89	7.87	3.5	2
2SPL-46B (in)	17.72	20.08	12.79	14.56	10.16	0.98	12.80	19.80	14.17	46.10	21.06	1.97	15.75	9.41	11.61	4-0.94	1.93	4.49	2.17	0.63	6	4
2SPL-46B (mm)	450.09	510.03	324.87	369.82	258.06	24.89	325.12	502.92	359.92	1170.94	534.92	50.04	400.05	239.01	294.89	4-24	49.02	114.05	55.12	16.00	12	10
3.5SPL-36D (in)	26.77	29.92	13.77	13.77	8.46	1.97	13.78	18.43	14.17	46.51	22.91	1.97	15.75	9.02	11.14	4-1.18	1.93	4.49	2.17	0.63	5	3.5
3.5SPL-36D (mm)	679.96	759.97	349.76	349.76	214.88	50.04	350.01	468.12	359.92	1181.35	581.91	50.04	400.05	229.11	282.96	4-30	49.02	114.05	55.12	16.00	10	8
4SPL-42F (in)	20.08	17.72	13.77	14.96	9.84	0.98	12.80	19.21	14.17	46.42	19.69	1.97	15.75	9.45	11.61	4-0.94	1.93	4.49	2.17	0.63	6	4
4SPL-42F (mm)	510.03	450.09	349.76	379.98	249.94	24.89	325.12	487.93	359.92	1179.07	500.13	50.04	400.05	240.03	294.89	4-24	49.02	114.05	55.12	16.00	12	10
6SPL-60G (in)	35.43	39.37	20.07	21.14	14.57	2.17	19.69	25.91	25.98	61.85	32.44	2.28	20.08	14.17	13.62	4-1.57	2.80	6.50	3.15	0.87	8	6
6SPL-60G (mm)	899.92	1000.00	509.78	536.96	370.08	55.12	500.13	658.11	659.89	1570.99	823.98	57.91	510.03	359.92	345.95	4-40	71.12	165.10	80.01	22.10	14	12
8SPL-60G (in)	35.43	39.37	20.07	20.98	14.96	2.17	19.61	25.91	25.98	62.72	32.44	2.28	20.08	14.61	14.06	4-1.57	2.80	6.50	3.15	0.87	10	8
8SPL-60G (mm)	899.92	1000.00	509.78	532.89	379.98	55.12	498.09	658.11	659.89	1593.09	823.98	57.91	510.03	371.09	357.12	4-40	71.12	165.10	80.01	22.10	14	12
10SPL-65J (in)	43.70	47.24	24.02	25.59	16.14	2.56	23.62	29.45	31.89	75.31	39.37	2.17	24.80	15.43	17.20	4-1.57	3.58	7.28	3.94	1.10	12	10
10SPL-65J (mm)	1109.98	1199.90	610.11	649.99	409.96	65.02	599.95	748.03	810.01	1912.87	1000.00	55.12	629.92	391.92	436.88	4-40	90.93	184.91	100.08	27.94	14	12
12SPL-56L (in)	43.70	47.24	20.86	19.96	15.75	2.56	20.87	29.45	31.89	76.22	39.37	2.56	24.80	16.10	17.48	4-1.57	3.58	7.28	3.94	1.10	14	12
12SPL-56L (mm)	1109.98	1199.90	529.84	506.98	400.05	65.02	530.10	748.03	810.01	1935.99	1000.00	65.02	629.92	408.94	443.99	4-40	90.93	184.91	100.08	27.94	14	12
12SPL-65M (in)	30.71	33.86	24.41	26.38	18.50	2.36	29.53	29.84	24.80	72.02	34.25	2.56	29.13	14.76	17.68	4-2.36	3.62	6.30	3.94	1.10	14	12
12SPL-65M (mm)	780.03	860.04	620.01	670.05	469.90	59.94	750.06	757.94	629.92	1829.31	869.95	65.02	739.90	374.90	449.07	4-60	91.95	160.02	100.08	27.94	14	12
2.5SPH-39C (in)	17.01	19.37	13.88	14.84	8.66	1.77	14.19	18.70	16.34	54.31	22.83	1.77	13.39	15.77	12.99	4-0.87	2.28	5.91	2.56	0.71	3.5	2.5
2.5SPH-39C (mm)	432.05	492.00	352.55	376.94	219.96	44.96	360.43	474.98	415.04	1379.47	579.88	44.96	340.11	400.56	329.95	4-35	57.91	150.11	65.02	18.03	4	3.5
3.5SPH-48E (in)	22.05	25.04	14.17	17.52	10.98	1.97	15.08	22.05	20.47	62.91	28.54	2.83	17.32	17.76	11.65	4-1.14	2.80	7.99	3.15	0.87	4	3.5
3.5SPH-48E (mm)	560.07	636.02	359.92	445.01	278.89	50.04	383.03	560.07	519.94	1597.91	724.92	71.88	439.93	451.10	295.91	4-29	71.12	202.95	80.01	22.10	6	4
4SPH-50E (in)	22.05	25.04	15.55	18.39	11.42	1.97	15.51	23.50	20.47	67.64	28.54	2.83	17.32	18.39	15.83	4-1.14	2.80	7.99	3.15	0.87	6	4
4SPH-50E (mm)	560.07	636.02	394.97	467.11	290.07	50.04	393.95	596.90	519.94	1718.06	724.92	71.88	439.93	467.11	402.08	4-29	71.12	202.95	80.01	22.10	8	6
6SPH-74H (in)	22.92	33.07	24.37	26.93	17.83	2.36	25.79	32.28	25.59	78.98	39.88	4.65	22.05	24.21	15.28	4-1.38	4.29	7.87	4.72	1.26	8	6
6SPH-74H (mm)	582.17	839.98	619.00	684.02	452.88	59.94	655.07	819.91	649.99	2006.09	1012.95	118.11	560.07	614.93	388.11	4-35	108.97	199.90	119.89	32.00	10	8
8SPH-74H (in)	22.92	33.07	26.57	28.93	18.11	2.36	27.36	34.65	25.59	87.13	39.88	4.65	22.05	24.72	22.80	4-1.38	4.29	7.87	4.72	1.26	10	8
8SPH-74H (mm)	582.17	839.98	674.88	734.82	459.99	59.94	694.94	880.11	649.99	2213.10	1012.95	118.11	560.07	627.89	579.12	4-35	108.97	199.90	119.89	32.00	12	10
10SPH-74K (in)	30.71	37.40	25.39	27.95	18.11	2.36	26.78	38.35	25.59	85.04	38.50	5.04	21.65	24.72	19.69	4-1.57	4.29	7.87	4.72	1.26	12	10
10SPH-74K (mm)	780.03	949.96	644.91	709.93	459.99	59.94	680.21	974.09	649.99	2160.02	977.90	128.02	549.91	627.89	500.13	4-40	108.97	199.90	119.89	32.00	14	12
12SPH-76K (in)	30.71	37.40	25.55	30.15	18.70	2.36	26.61	34.76	25.59	89.84	38.50	5.04	21.65	26.77	24.02	4-1.57	4.29	7.87	4.72	1.26	14	12
12SPH-76K (mm)	780.03	949.96	648.97	765.81	474.98	59.94	675.89	882.90	649.99	2281.94	977.90	128.02	549.91	679.96	610.11	4-40	108.97	199.90	119.89	32.00	14	12



ACCELERATE Your ROI. Ask for ATLAS.

Certified Service & Repair

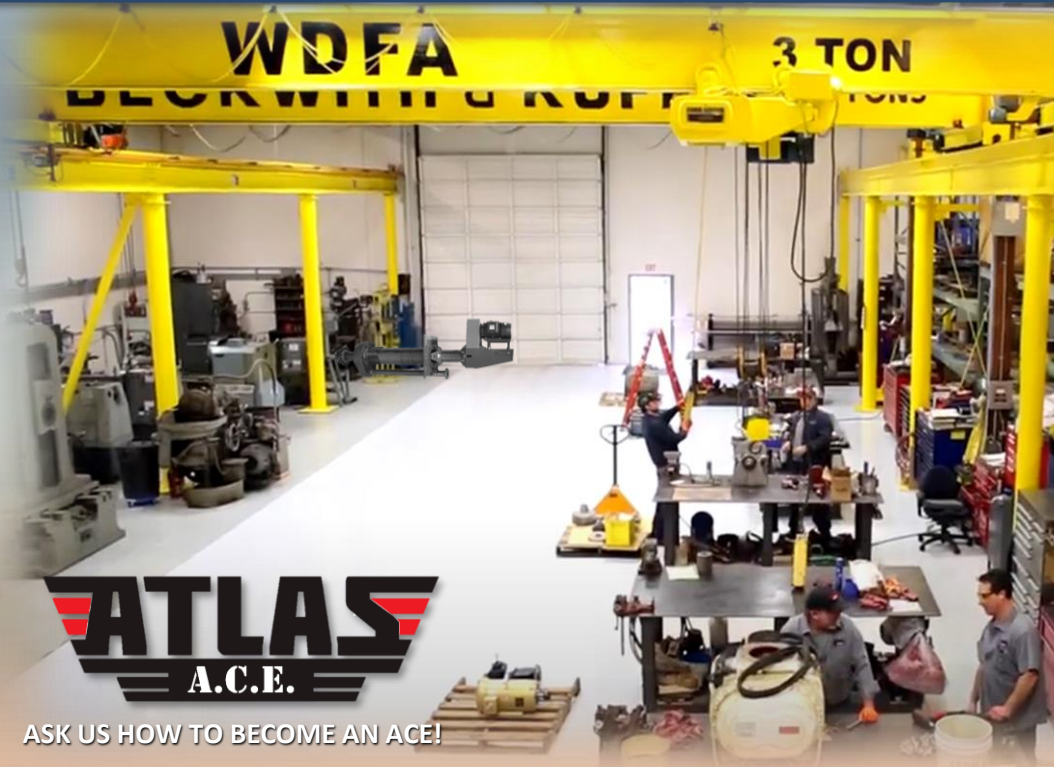

ASK US HOW TO BECOME AN ACE!

Our machine shops are among the best in the industry. Covering a combined total of 50,000+ square feet, you can rest assured that we have the parts and capabilities needed to get your job done right the first time, every time.

Looking for OEM Replacement Parts? We have them!

We understand how critical unplanned downtime is to your business, which is why we offer

24-7-365 EMERGENCY Service!

Service ... to the MAX



Service to Exceed Expectations

Mountain Born ...



... Atlas-Tough®

Contact us today for your slurry equipment needs. Let us partner with you to improve your plant's operations!

1-866-808-2950

: www.atlaseqco.com

ATLAS
EQUIPMENT CO.

Atlas Equipment Co. II, Inc.
1313 South 96th Street
Seattle, WA 98108

Copyright © 2022 Atlas Equipment Co., II, LLC Designed by BDS